

**NOTES: (UNLESS OTHERWISE SPECIFIED)**

1. ALL DIMENSIONS ARE IN mm OTHERWISE NOTED.
2. LINEAR SPECIFICATION:  
 FORCE STROKE: 15 +/-0 mm  
 FORCE CONSTANT: 2.7 N/AMP  
 PEAK FORCE: 3.8 N @ 1.5 AMPS (24 VDC)  
 CONTINUE FORCE : 2.7 N @ 1 AMPS (24 VDC)  
 COIL DC RESISTANCE: 13 OHMS @ 22°C  
 ENDODER RESOLUTION: 0.1, 0.5, 1.0, 5.0 Microns  
 ENDODER ACCURACY: ± 4 Counts  
 THEIA SPECIFICATION: (DIRECT OUTPUT SHAFT)  
 ROTATION ANGLE: 380° FULL  
 PEAK TORQUE: 8.4 mNm (0.5 Amps , 24 VDC)  
 CONTINUE TORQUE: 2.4 mNm @ 0.3 Amps (24 DCV)  
 MAXIMUM RPM : 2000 (WITH 0 LEAD & VACUUM)  
 GEAR RATIO: NONE  
 ROTARY MOTOR TYPE: DC BRUSH  
 ENDODER RESOLUTION: 20,000 CPR (0.018 / STEP)  
 ENCODER ACCURACY: ± 5 COUNTS (σ BACK LASH)  
 MOVING MASS: 70 GRAMS  
 TOTAL MASS: 250 GRAMS  
 OPERATING TEMPERATURE: 0°C TO 40°C
- 3.
- 4.
- 5.
- 6.

DESCRIPTION	DESCRIPTION
1. #10	1. #10
2. E. PHASE A - (Q)	2. E. PHASE A - (Q)
3. E. PHASE B - (Q)	3. E. PHASE B - (Q)
4. E. PHASE C - (Q)	4. E. PHASE C - (Q)
5. E. INDEX - (Q)	5. E. INDEX - (Q)
6. E. PHASE A - (R)	6. E. PHASE A - (R)
7. E. PHASE B - (R)	7. E. PHASE B - (R)
8. E. PHASE C - (R)	8. E. PHASE C - (R)
9. E. INDEX - (R)	9. E. INDEX - (R)
10. E. PHASE A - (L)	10. E. PHASE A - (L)
11. E. PHASE B - (L)	11. E. PHASE B - (L)
12. E. PHASE C - (L)	12. E. PHASE C - (L)
13. E. INDEX - (L)	13. E. INDEX - (L)
14. LMT - (L)	14. LMT - (L)
15. LMT - (R)	15. LMT - (R)
16. LMT - (Q)	16. LMT - (Q)
17. LMT - (R)	17. LMT - (R)
18. LMT - (L)	18. LMT - (L)
19. R. MOTOR -	19. R. MOTOR -
20. R. MOTOR +	20. R. MOTOR +
21. R. MOTOR -	21. R. MOTOR -
22. R. MOTOR +	22. R. MOTOR +
23. R. MOTOR -	23. R. MOTOR -
24. R. MOTOR +	24. R. MOTOR +
25. R. MOTOR -	25. R. MOTOR -
26. R. MOTOR +	26. R. MOTOR +
27. R. MOTOR -	27. R. MOTOR -
28. R. MOTOR +	28. R. MOTOR +
29. R. MOTOR -	29. R. MOTOR -
30. R. MOTOR +	30. R. MOTOR +

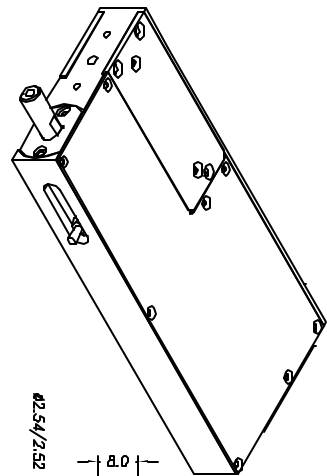

SIGNATURE NEEDED FOR ORDER APPROVAL  
 DATE \_\_\_\_\_  
 APPROVAL NOT RECEIVED WITHIN  
 48 HOURS MAY AFFECT DELIVERY

REV	DATE	ECN	DESCRIPTION	APP
A	8/29/03	2900	INITIAL RELEASE	SMH
B	3/5/04	3068	SEE ECN	SMH
C	3/12/04	3097	ADDED FRONT LIMIT	C.A.W.
D	6/25/04	3236	MODIFIED MOUNTING	SMH
E	9/7/04	3311	SEE ECN	SMH
F	2/16/05	3496	SEE ECN	JIN

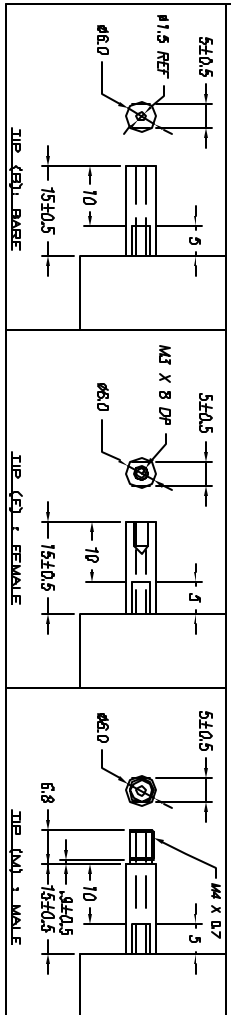
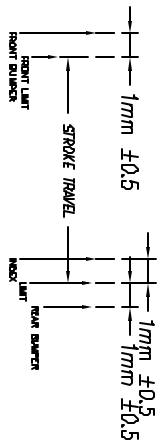
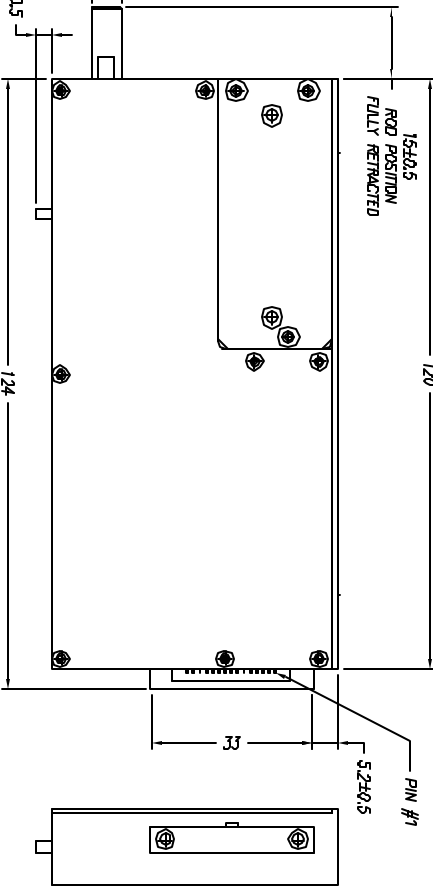
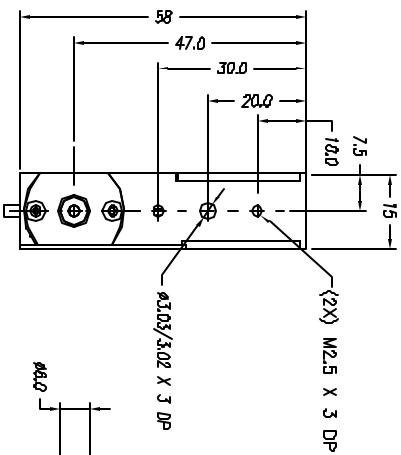

TOLERANCES ARE:	MATERIAL:		DESIGNED BY:		DATE:	
X ± 0.50	ALUMINUM	JOHN VU	01/21/04	CHECKED BY:		DATE:
XX ± 0.1	6061-T6	DRN: BTV	01/21/04	APPROVED BY:		DATE:
XXX ± 0.05	HEAT TREAT:	INVT	01/21/04	PART NUMBER:		CONTRIN:
XXXX ± 0.05	RC	DEEP	01/21/04	LAR15-015-5		STD
XXXXX ± 0.1	ANODIZE:	3.2	01/21/04	SHEET NUMBER:		1 OF 1
XXXXXX ± 0.17	ROUNDNES:	0.2 MAX		DRAWING SCALE:		
XXXXXXX ± 0.05	EDGE BREAK:	0.2 MAX		DWG SIZE:		
XXXXXXX ± 0.2 MAX	SHAFTER:			PART NUMBER:		
	EXCEPT NOTES:			LAR15-015-5		
	PROTECTIVE FINISH:			DRAWING SCALE:		
	ELECTROLESS NICKEL			DWT NOT SCALE TIME		
	SPEC. NUMBER:			DWT NOT SCALE TIME		

**SMAC**

REF. NUMBER  
**LAR15-015**