

NOTES: (UNLESS OTHERWISE SPECIFIED)

1. ALL DIMENSIONS ARE IN mm
2. LINEAR SPECIFICATION:
LINEAR STROKE: 50 +1.0/-0 mm
FORCE CONSTANT: 125 N/AMP (EST.)
PEAK FORCE: 500 N @ 4 AMPS (48 VDC) (EST.)
COIL DC RESISTANCE: 12 Ω 20°C (48 VDC)
COIL INDUCTANCE: TBD mH @ 1 KHZ
ENCODER RESOLUTION: 5.0, 1.0, 0.5 μm
ENCODER ACCURACY: ±5 μm
3. MOVING MASS: 3.1 Kg (EST.)
4. TOTAL MASS: 34 Kg (EST.)
5. OPERATING TEMPERATURE: 5°C TO +40°C
6. LIMIT+/LIMIT- DETECT METHOD HALL EFFECT
(HIGH Vcc: LOW 0.7V MAX)
7. OPERATING HUMIDITY RANGE: 35 TO 85 %RH

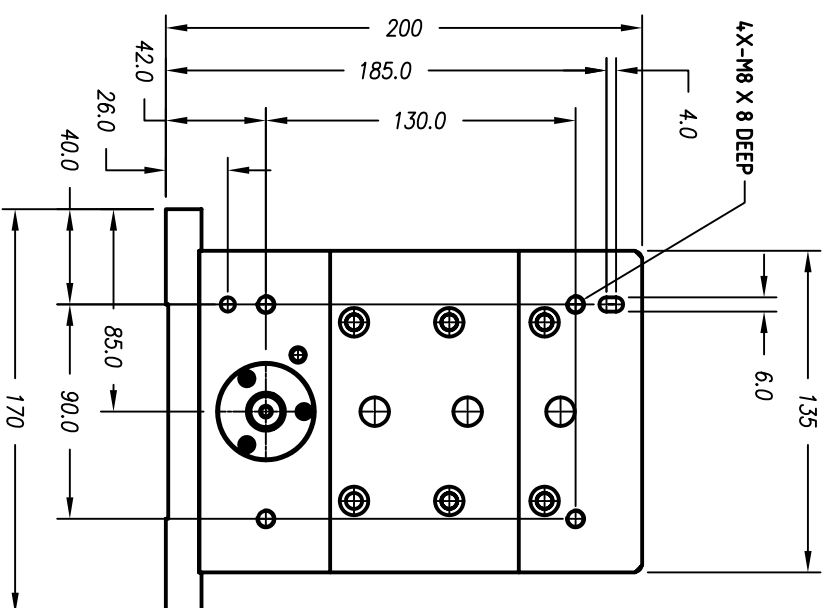

SIGNATURE NEEDED FOR ORDER APPROVAL
SIGN _____ DATE _____
APPROVAL NOT RECEIVED WITHIN
48 HOURS MAY AFFECT DELIVERY

REV	DATE	ECN	DESCRIPTION	APP
A	4/26/06	3916	INITIAL RELEASE	TW
B	9/6/06	4018	SEE ECN	LR
C	9/15/06	4022	SEE ECN	LR

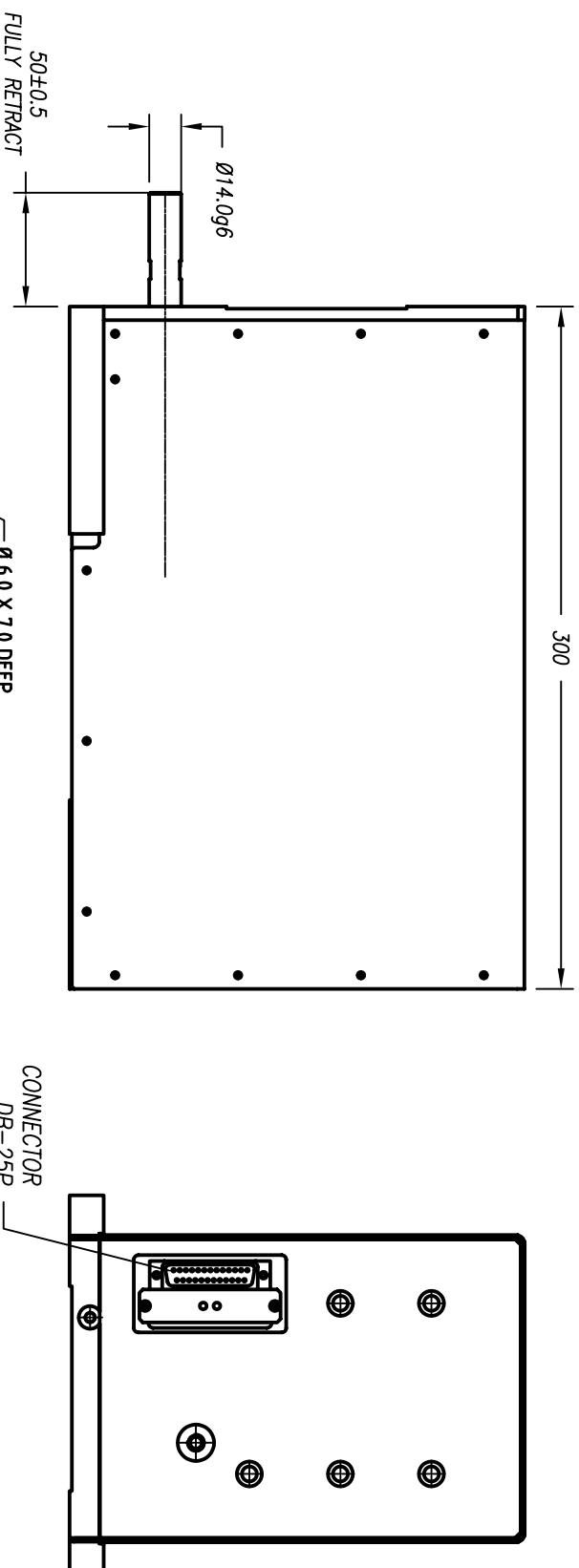

DB-25P CONNECTOR PIN OUT (AXIS 1=LINEAR)	
1	+5VDC
2	+5V RETURN
3	NC
4	AXIS 1 ENCODER PHASE A-
5	OVER HEAT
6	AXIS 1 LIMIT/OH RETURN
7	AXIS 1 MOTOR +
8	AXIS 1 MOTOR -
9	AXIS 1 ENCODER PHASE B-
10	NC
11	AXIS 1 LIMIT +
12	AXIS 1 LIMIT -
13	NC
14	AXIS 1 ENCODER PHASE A+
15	NC
16	AXIS 1 ENCODER PHASE B+
17	NC
18	AXIS 1 ENCODER INDEX Z+
19	AXIS 1 MOTOR -
20	AXIS 1 MOTOR +
21	NC
22	NC
23	AXIS 1 ENCODER INDEX Z-
24	NC
25	NC

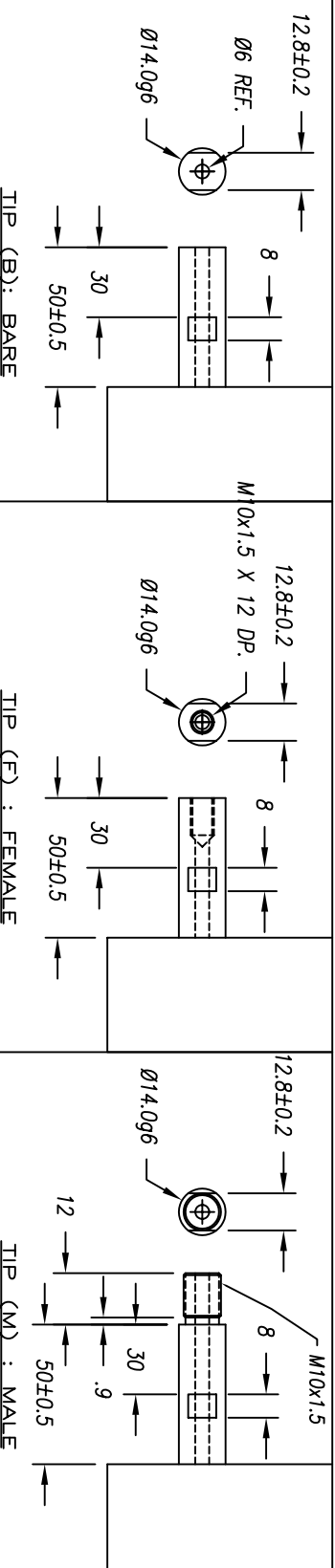
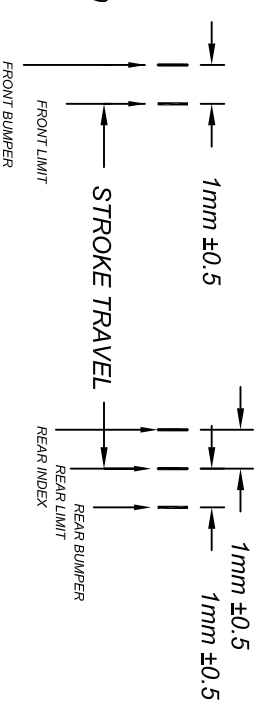
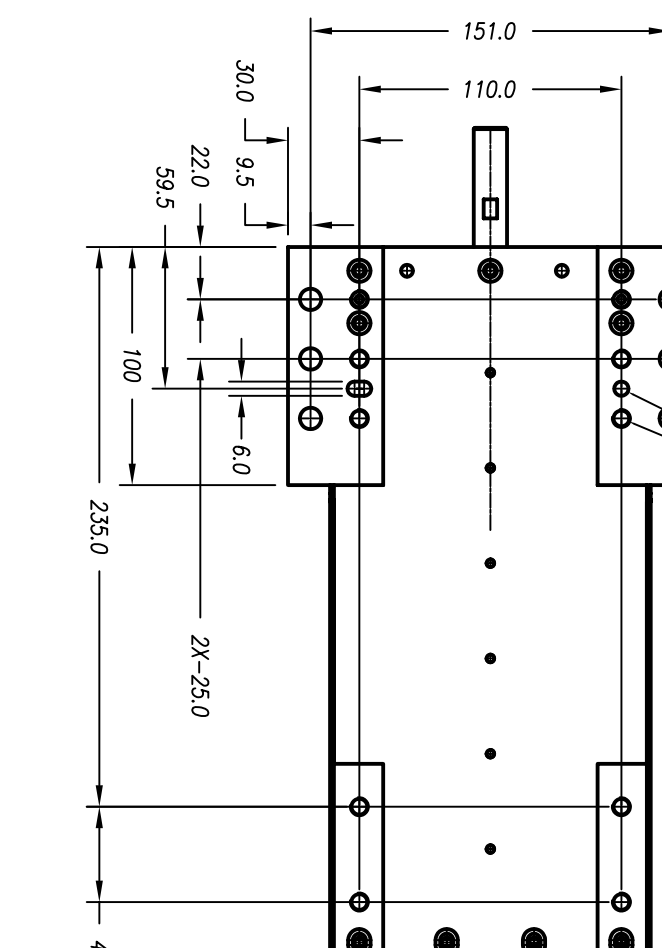

TOLERANCES ARE:		MATERIAL:		DESIGNED BY:		DATE:		CHECKED BY:		DATE:		CONTRACT:	
X	±	0.50	ALUMINUM	TOAN	VU	4/26/06							
XX	±	0.1	6061-T6										
XXX	±	0.05											
X.XXX	±	0.01											
ANGULARITY	±	0.1°											
CONCENTRIC	±	0.01											
ROUNDNESS	±	0.05											
EDGE BREAK		0.2 MAX											
CHAMFER		0.2 MAX											
FILE NAME:	LAL500-050-8												
SPEC. NUMBER:	6061-T6												
HEAT TREAT:	RC												
MACHINE FINISH:	3.2 / DEEP												
EXCEPT NOTED:	✓												
PROTECTIVE FINISH	ELECTROLESS NICKEL												
SCALE:	NONE												
DWG SIZE:	B												
PART NUMBER:	LAL500-050-8												
REF. NUMBER:	LAL500-050-8												
SHEET NUMBER:	1 OF 1												
REVISION:	C												

SMAC REF. NUMBER: LAL500-050-8